



ULI Nashville

EXCELLENCE IN DEVELOPMENT

AN EVENING TO CELEBRATE TOGETHER THE ULI NASHVILLE
EXCELLENCE IN DEVELOPMENT AWARDS. THIS SPECIAL EVENT
WILL SHOWCASE ULI NASHVILLE'S ENDURING COMMITMENT TO
COMMUNITY AND LIVABILITY, VALUED PARTNERS AND MEMBERS,
AND EXCELLENCE IN DEVELOPMENT, DESIGN AND USE OF LAND.

best practices

community

best practices

livability

education

DIAMOND AWARDS SPONSORS 2021

core

GIARRATANA



DIAMOND AWARDS SPONSORS 2021



Turner

GOLD AWARDS SPONSORS 2021



Brookfield
Properties



MIKEN
DEVELOPMENT, LLC



SOUTHERN LAND
COMPANY



HASTINGS

waller



SILVER AWARDS SPONSORS 2021

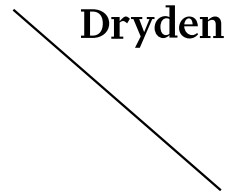

SILVER AWARDS SPONSORS 2021

Kimley»Horn

MarketStreet™
ENTERPRISES

Messer
WeAreBuilding.

SMITH
GEE
STUDIO

Stantec

SG
DESIGN

OHM
Advancing Communities®

PANATTONI®

80 YEARS
R.C. MATHEWS
CONTRACTOR

STUDIO
A BOUTIQUE BANK

THOMAS
&
HUTTON

tm
p

RaganSmith

&

SKANSKA

SILVER AWARDS SPONSORS 2021

ULI Nashville Excellence in Development Awards 2021

The ULI Nashville Excellence in Development Awards provides an evening to come together to celebrate ULI Nashville's Excellence in Development Awards. The Awards represent the mission that strong communities, good development partners, and excellence in development and design should be recognized, and best practices should be shared and celebrated.

The health, climate and socio-political challenges affecting the world, including our community, can easily curtail that lofty mission to celebrate; and it certainly has affected the way in which we can "come together" safely. However, come together we will!

Even in these difficult times, ULI Nashville showcases and supports the ways our community and our ULI members are resilient and excel in helping shape our way forward, and how, working together, we overcome these obstacles to build a better future.

Judging Criteria 2021

Interviews with representatives from all of the 20 projects will be posted for viewing on the ULI Nashville website. You are invited to watch each of those informative interviews on the excellent projects of the 2021 ULI Nashville Excellence in Development Awards.

Projects submitted in 2021 represent some of our region's best development.

Each entry was judged on criteria that support ULI's commitment to best practices in the use of land. The judges used careful deliberation in assessing each project according to all of the Awards' Evaluation Criteria:

- **FINANCIAL VIABILITY and OPERATIONAL STABILITY** — Demonstrated to be a sound financial investment and proven market success.
- **EXCELLENCE and INNOVATION** — Demonstrated in areas of land use, design, development, construction, etc.
- **EXCELS IN ADDED-VALUE FEATURES** — Demonstrates excellence in added-value elements to the market/community/industry, such as:
 - promotes healthy lifestyles and builds for a healthier community;
 - responds to community affordability challenges;
 - protects the environment in construction or in building materials, and promotes environmental stewardship and sustainable lifestyle;
 - sensitive to a demonstrated community need;
 - reflects the character of the community;
 - provides a catalytic effect on other development.
- **WORTHY OF EMULATION** — Responds to ULI/ULI Nashville Principles and Priorities and creates a high standard of industry excellence, sets a new paradigm, introduces a new technique, stands out among other excellence.

"Nashville showed us an abundance of excellence across its region and across project size, sector and asset class. We were presented with the 'best of the best' and needed to scrutinize the comprehensive evaluation criteria to identify those projects worthy of emulation." — Judges

8TH & GALE



Developer
 Owner
 Architect
 Contractor
 Landscape Architect
 Civil Engineer
 Finance/Banking
 MEP Project Manager
 Structural Engineer

Fidelity Real Estate Group, Inc.
Pinnacle Financial Partners
Architect Workshop
Flow Construction Company, Inc.
Kimley-Horn and Associates, Inc.
Kimley-Horn and Associates, Inc.
Pinnacle Financial Partners
Dewberry | Edmonds
EMC Structural Engineers, P.C.

BELCOURT VILLAGE



Developer
 Architect
 Contractor
 Landscape Architect
 Civil Engineer
 Finance/Banking
 Transportation Engineer
 Geo Professionals
 Structural Engineer
 MEP Engineer

Elmington Capital Group
Southeast Venture Design, LLC
Elmington Construction, LLC
HDLA
Kimley-Horn and Associates, Inc.
Pinnacle Bank and Financial Partners
Kimley-Horn and Associates, Inc.
Terracon Consultants, Inc.
EMC Structural Engineers, P.C.
I.C. Thomasson Associates, Inc.



BENTO LIVING CHESTNUT HILL



Developer
Architect
Contractor
Landscape Architect
Civil Engineer
Structural Engineer

Bento Living
EOA Architects, PLLC
BL Harbert
S & ME, Inc.
S & ME, Inc.
EMC Structural Engineers, P.C.



BRACKEN FOUNDATION CHILDREN'S GARDEN AT CHEEKWOOD ESTATE & GARDENS

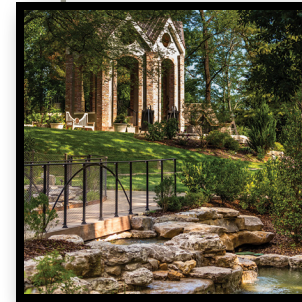

Developer
Architect
Contractor
Landscape Architect
Civil Engineer
Other Dev. Team Members

Cheekwood Estate & Gardens
Hastings Architecture, LLC
Carter Group, LLC
HDLA
CSDG
Pillars Development
WISEngineers, Inc.



BROADWEST



Developer
 Architect
 Contractor
 Landscape Architect
 Civil Engineer
 Geo Professionals
 Structural Engineer
 MEP Engineer

Propst Development
Cooper Carry, Inc.
Turner Construction Company
Cooper Carry, Inc.
Catalyst Design Group
PSI, Inc.
Stanley D. Lindsey and Associates
The Thompson Ehle Company



EAST GREENWAY PARK



Developer
 Architect
 Contractor
 Landscape Architect
 Civil Engineer
 Finance/Banking

Aerial Development Group LLC
Aerial Development Group LLC
Paragon Group LLC
Hawkins Partners, Inc.
CSDG
Pinnacle Financial Partners



FIFTH + BROADWAY

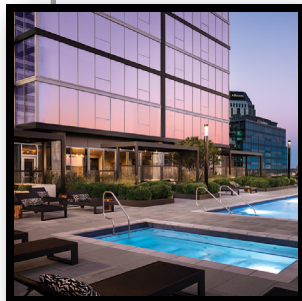

Developer
 Architect
 Contractor
 Landscape Architect
 Civil Engineer
 Finance/Banking
 Transportation Engineer
 Geo Professionals
 Structural Engineer
 MEP Project Manager

Brookfield Properties
Gresham Smith
Skanska
Hawkins Partners, Inc.
Gresham Smith
Quand Real
KCI Technologies, Inc
PSI, Inc.
Stanley D. Lindsey & Associates
Alvine Engineering



HARPETH SQUARE

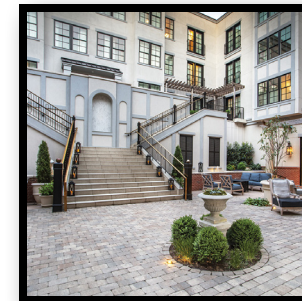

Developer
 Owner
 Design Architect: Exteriors
 Architect of Record
 Contractor
 Landscape Architect
 Civil Engineer of Record
 Civil Engineer
 Finance/Banking
 Finance/Banking
 Finance/Banking
 Interior Designer:
 Harpeth Square Apartments
 Interior Designer:
 Harpeth Square Hotel
 Structural Engineer
 MEP & Fire Protection
 Engineers
 Lighting Consultant
 LEED/Green Building Consultant

Harpeth Associates, LLC
Valor Hospitality
906 Studio Architects
Smith Gee Studio
R.C. Mathews Contractor
Gamble Design Collaborative
Civil & Environmental Consultants
Gresham Smith Partners
Walker & Dunlop
Franklin Synergy (now FirstBank)
Capstar Bank
Smith Gee Studio

The Hotel Studio

Genesis Engineering Group
Genesis Engineering Group

Archiluce International
Wilmot



HATHORNE RESTAURANT



Developer
 Architect
 Contractor
 Civil Engineer
 Finance/Banking
 Structural Engineer
 MEP Engineer

Sylvan Partners, LLC
Dryden Architecture + Design, PLLC
Steelhead Building Group, LLC
CSDG
Truxton Trust
PWP Structural Engineers, LLC
Dewberry | Edmonds



ILLUME



Developer
 Developer
 Developer
 Developer
 Owner
 Architect
 Contractor
 Landscape Architect
 Civil Engineer
 Finance/Banking
 Transportation Engineer
 Geo Professionals
 Structural Engineer
 MEP Engineer

THRE3, LLC
Armistead Arnold Pollard Real Estate
The Bradley Development Group
CA South
Illume Nashville, LLC
The Bradley Projects
Certified Construction Services
Heibert + Ball Land Design
Fulmer Lucas
Knighthood Funding
Burch Transportation
Terra Nova Engineering
Brewer Engineering and Consulting Services
Harpeth Park Engineering



KOSSIE GARDNER SR. PARK



Developer
 Contractor
 Landscape Architect
 Civil Engineer
 Other Dev. Team Members

Metropolitan Board of Parks and Recreation
CDSC, Inc.
HDLA
Collier Engineering
Nashville Civic Design Center



MARS PETCARE AT OVATION EAST END

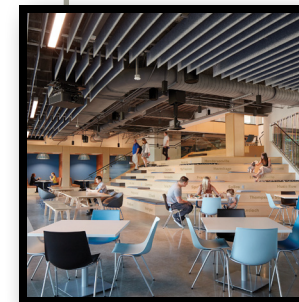
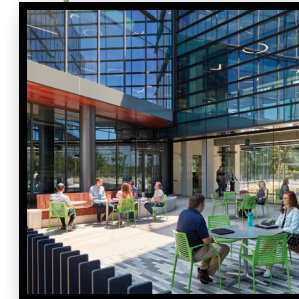
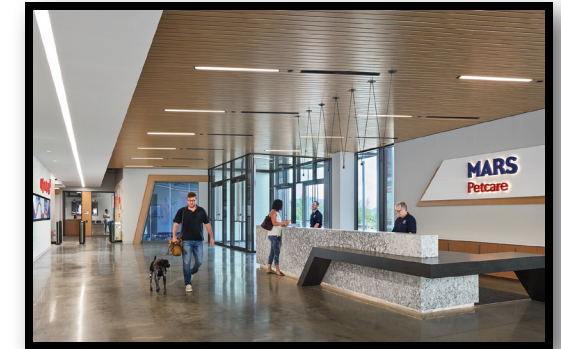

Developer
 Architect
 Contractor
 Landscape Architect
 Civil Engineer
 Structural Engineer
 Lighting
 MEP Engineering
 Graphics
 Furniture

Highwoods Properties
Hastings Architecture, LLC
Brasfield & Gorrie, LLC
Hawkins Partners, Inc.
Barge Cauthen & Associates
EMC Structural Engineers, P.C.
LAM Partners
Empower Electric
Cloud Gehshan Associates
Alfred Williams & Company



MTSU ACADEMIC CLASSROOM



Developer
 Owner
 Architect
 Contractor
 Landscape Architect
 Civil Engineer
 Structural Engineer
 MEP Engineer

State Of Tennessee Board of Regents
Middle Tennessee State University
Bauer Askew Architecture
Turner Construction Company
HDLA
Barge Cauthen and Associates
PWP Structural Engineers
I.C. Thomasson Associates, Inc.



NASHVILLE INTERNATIONAL AIRPORT
 CONCOURSE D AND TERMINAL WINGS

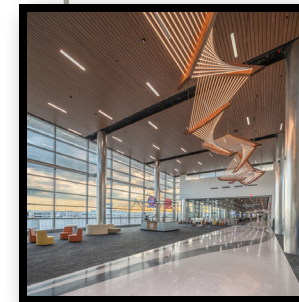
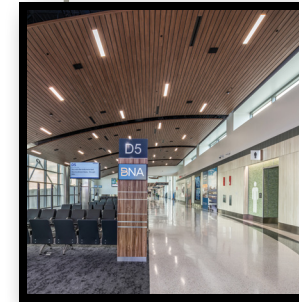

Developer
 Architect
 Contractor
 Landscape Architect
 Civil Engineer
 Transportation Engineer
 Structural Engineer
 MEP Engineer
 Electrical
 Mechanical and Plumbing
 Interior Specialties

Metropolitan Nashville Airport Authority
Fentress Architects
Hensel Phelps
S & ME, Inc.
S & ME, Inc.
S & ME, Inc.
Magnusson Klemenc Associates (MKA)
I.C. Thomasson, Inc
Wolfe and Travis Electric Co.
Nashville Machine Co. Inc.
ISEC, Inc.



OAKWOOD FLATS



Developer
 Architect
 Contractor
 Landscape Architect
 Civil Engineer
 Finance/Banking
 Transportation Engineer
 Geo Professionals
 Structural Engineer
 MEP Engineer

Elmington Capital Group, LLC
Shapiro & Company Architects, P.C.
BACAR Constructors, Inc.
Kimley-Horn and Associates, Inc.
Kimley-Horn and Associates, Inc.
Berkadia
Kimley-Horn and Associates, Inc.
Terracon Consultants, Inc.
DPC Engineers
Power Management Corporation

SEGMENT

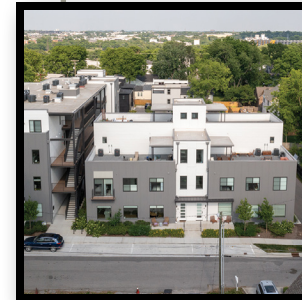

Developer
 Architect
 Contractor
 Landscape Architect
 Civil Engineer
 Finance/ Banking
 Geo Professionals
 Sales
 Marketing

Core Development
Manuel Zeitlin Architects, LLC
Highland Building Group
Hawkins Partners, Inc.
CSDG
First Farmers and Merchants Bank
Terra Nova Engineering
City Living Group
Solve



**TENNESSEE STATE LIBRARY
AND ARCHIVES**



Developer **State of Tennessee Real Estate Asset Management (STREAM)**

Architect **Thomas, Miller & Partners, LLC**

Architect **Tuck-Hinton Architects, PLC**

Contractor **Turner Construction Company**

Landscape Architect **Ross/Fowler Landscape Architects**

Civil Engineer **Barge Cauthen and Associates**

Geo Professionals **PSI, Inc.**

Structural Engineer **EMC Structural Engineers, P.C.**

MEP Engineer **I.C. Thomasson Associates, Inc.**



TREATY OAKS MASTER PLAN



Developer **MiKen Development LLC**

Owner **HR Properties of Tennessee**

Owner **Elmington Capital**

Architect **Centric Architecture**

Contractor **Highland Homes TN**

Contractor **Paragon Group**

Civil Engineer **CSDG**

Civil Engineer **Dale & Associates**

Civil Engineer **CESO**

Finance/Banking **Pinnacle Financial Partners**

Finance/Banking **First Citizens National Bank**

Geo Professionals **Terranova Engineering**





VANDERBILT UNIVERSITY E. BRONSON INGRAM RESIDENTIAL COLLEGE



Developer
 Architect
 Contractor
 Landscape Architect
 Civil Engineer
 Geo Professionals
 Structural Engineer
 MEP Engineer
 Food Service
 Acoustics
 Lighting
 Waterproofing

Vanderbilt University
Hastings Architecture, LLC
R.C. Mathews Contractor
HDLA
Barge Cauthen & Associates
TTL, Inc.
EMC Structural Engineers, P.C.
Smith Seckman Reid, Inc.
Ricca Design Studios
Charles M. Salter Acoustics
Coventry Lighting, Inc.
Hixson Consultants, Inc.



VERTIS GREEN HILLS

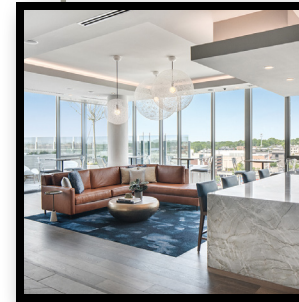

Developer
 Owner
 Architect
 Contractor
 Landscape Architect
 Civil Engineer
 Finance/Banking
 Transportation Engineer
 Geo Professionals
 Structural Engineers
 Mechanical Plumbing

Southern Land Company
Southern Land Company
Hastings Architecture, LLC
Southern Land Company Commercial Construction
Southern Land Company Planning and Landscape Architecture
Southern Land Company Civil Engineering
M&T Bank
KCI Technologies
Terra Nova Engineering, PLLC
Roger Moore Engineers
Mitchell Mechanical, LLC

Special Thanks

ULI Nashville and the ULI Nashville Excellence in Development Awards are indebted to the commitment and hard work of its member volunteers and supporters.

With Thanks:

John Dwyer, *Jobs for Tennessee Graduates* — Emcee

Gannaway Design — Graphic Design

Harbinger House — Videography

Mickey Bernal Photography — Event Photography

CSDG — Project Rep Interview Venue

ULI Nashville Awards Committee:

Nancy DeKalb, *DeKalb Communications*

Sheila Dial-Barton, *EOA Architects, PLLC*

Brittany Earlie, *Crain Construction, Inc.*

Chuck Gannaway, *Hastings Architecture, LLC*

Bart Mackey, *Stone Source*

Laura McCoy, *McCoy Design*

Dana Terebessy, *Carter Group, LLC*

Shonte Walton, *Fabric and Finish Interior Design*

Friends of the Awards

Alfred Benesch & Co.

American Constructors Inc.

Architect Workshop

Baker Barrios Architects

Bass Berry & Sims PLC

Barge Design Solutions, Inc.

Bell Construction

Boyle Nashville

Bristol Development Group

Carter Group

CA South

CBRE

CESO

Colliers International Nashville LLC

Dewberry | Edmonds

DPR Construction

ESa

FH Design

First Horizon Bank

HDLA

H.G. Hill Realty Company, LLC

HOAR Construction

Holladay Properties

JLL

Kiser & Vogrin Design, LLC

Patterson Real Estate Advisory Group, LLC

Pinnacle Financial Partners

Pond & Company

The Mathews Company

Truist

Information about ULI Nashville

For more information about ULI Nashville, member benefits, programs, resources, and activities, please email nashville@uli.org or call 615-497-2603. You may also find information at <https://nashville.uli.org> and uli.org.

For Social Media: Instagram @ULINashville and #ULINashvilleCommits
Twitter @ULI_Nashville

For information about becoming a member of ULI, please visit <https://www.uli.org>.

ULI Nashville Annual Sponsors

ULI Nashville values its Annual Sponsors, without whose support ULI Nashville's year-long educational, professional development, member networking and community outreach programming would not be possible. For a complete list of ULI Nashville Annual Sponsors, please visit <https://nashville.uli.org/sponsorship/>.

About ULI

Established in 1936, the Institute today has over 45,000 members worldwide and over 745 local middle TN members representing the entire spectrum of the land use and development industries. It is through member involvement and information resources that ULI has been able to set standards of excellence in development practice. The Institute has long been recognized as one of the world's most respected and widely quoted sources of objective information on land planning, real estate development, place-making, and smart growth. The Urban Land Institute (ULI) is a 501(c)(3) nonprofit research and education organization supported by its members worldwide. ULI neither lobbies nor acts as an advocate for any single industry.

