

Studies

Studies to show All

Building Options 2 017

Building Options 2
Dec 17, 2019, 2:09 PM 20/20 ✓

Building Options 2 016

Building Options 2
Dec 17, 2019, 2:03 PM 20/20 ✓

Building Options 2 015

Building Options 2
Dec 17, 2019, 1:54 PM 20/20 ✓

Building Options 2 014

Building Options 2
Dec 17, 2019, 1:51 PM 10/10 ✓

Building Options 2 013

Dec 17, 2019, 1:48 PM 1/10 ▶

Building Options 2 012

Dec 17, 2019, 1:42 PM 0/20 ▶

Building Options 2 011

Building Options 2
Dec 17, 2019, 1:41 PM 10/10 ✓

Create Study

Building Options 2 017

Sort by Total Floor Area ↑

1 2 3 4 5 6 7

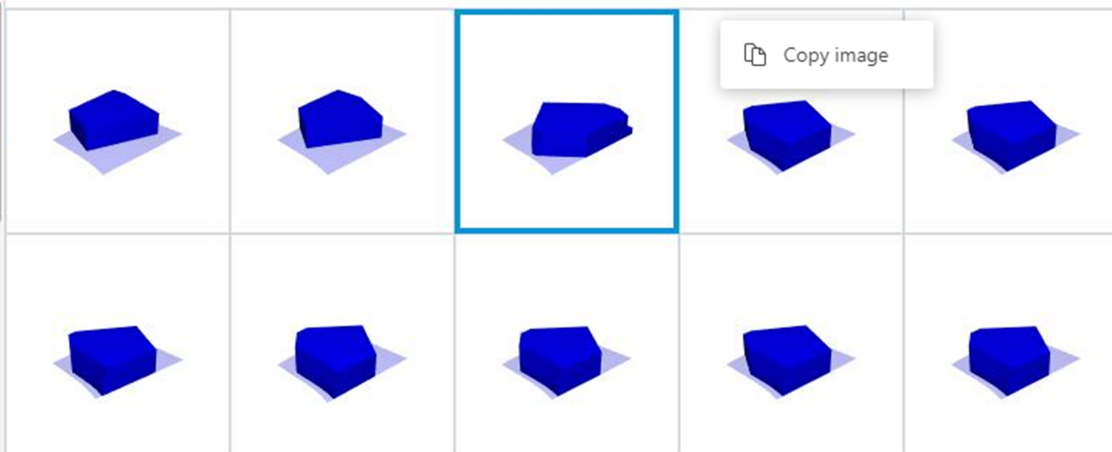

Filter

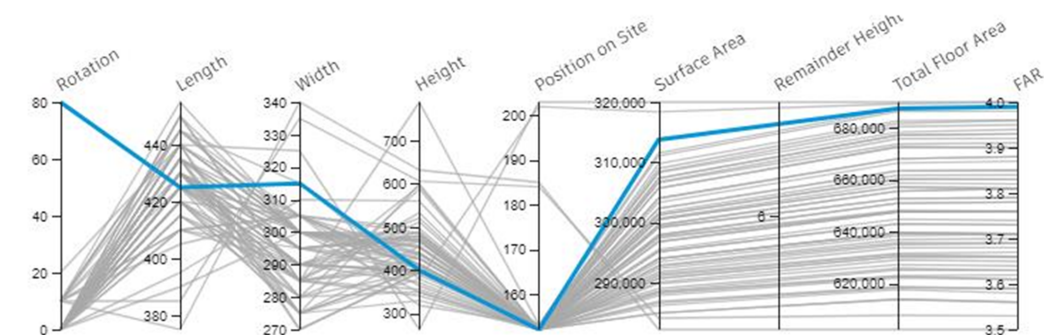

20 of 20

Charts Details

Details

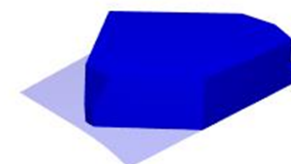

Outputs

Surface Area	313786.0
Remainder Height	6.0
Total Floor Area	687578.0
FAR	3.990
Height	96.0

Inputs

Rotation	80
Length	425
Width	315
Height	400

← →

Open in Dynamo

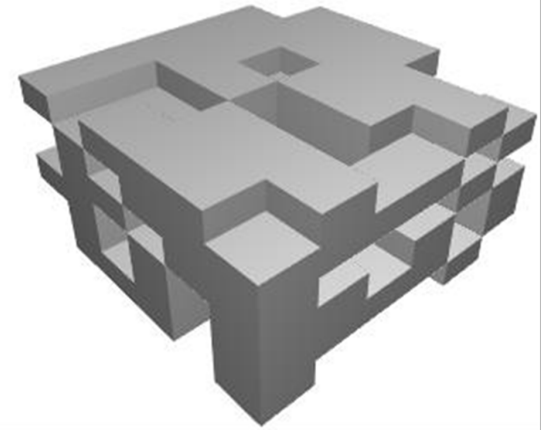
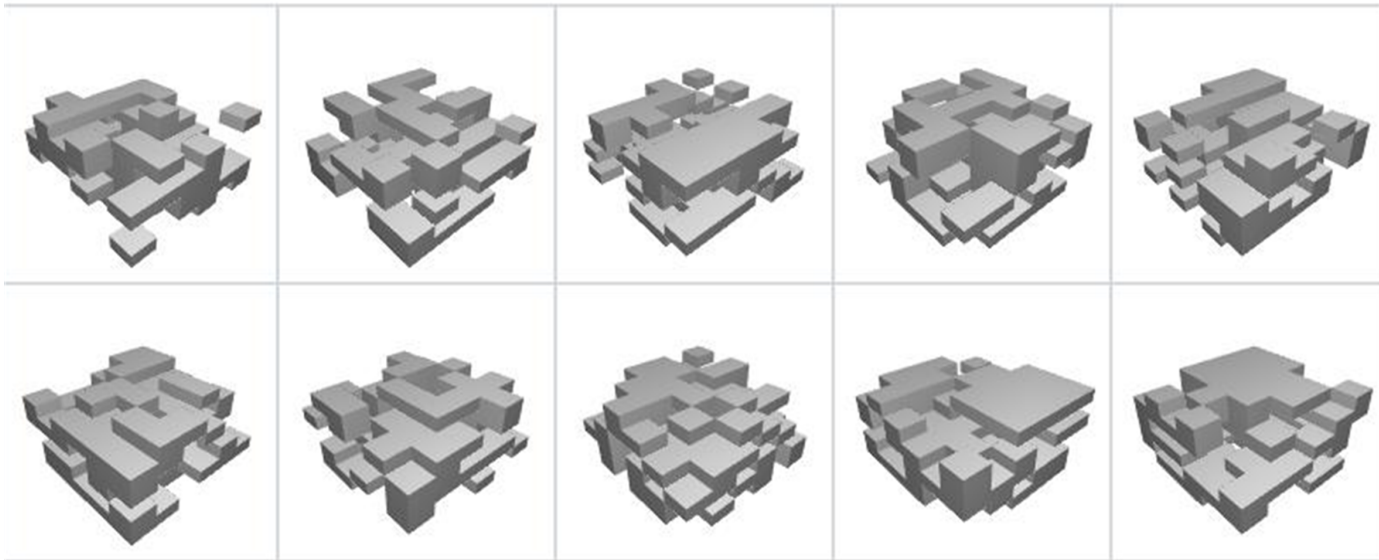

Outputs

Views to Exterior	60300.0
Floor Area	71100.0

Inputs

Random Seed	373115
-------------	--------



Filter

- Y-Axis: Views to Exterior
- X-Axis: Floor Area
- Size: Default
- Color: Default

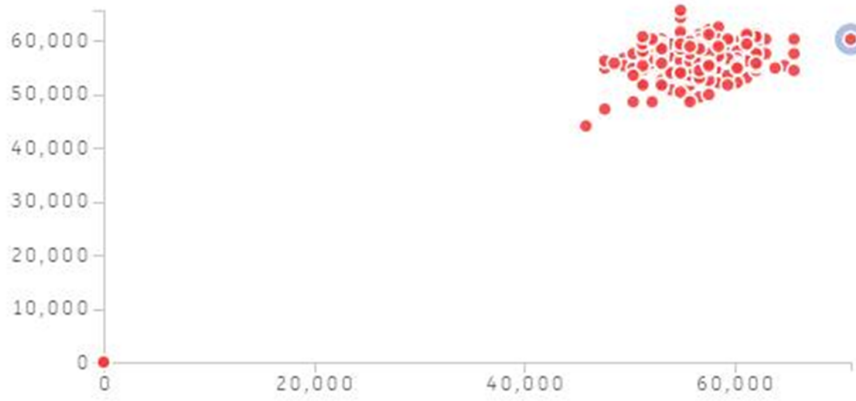

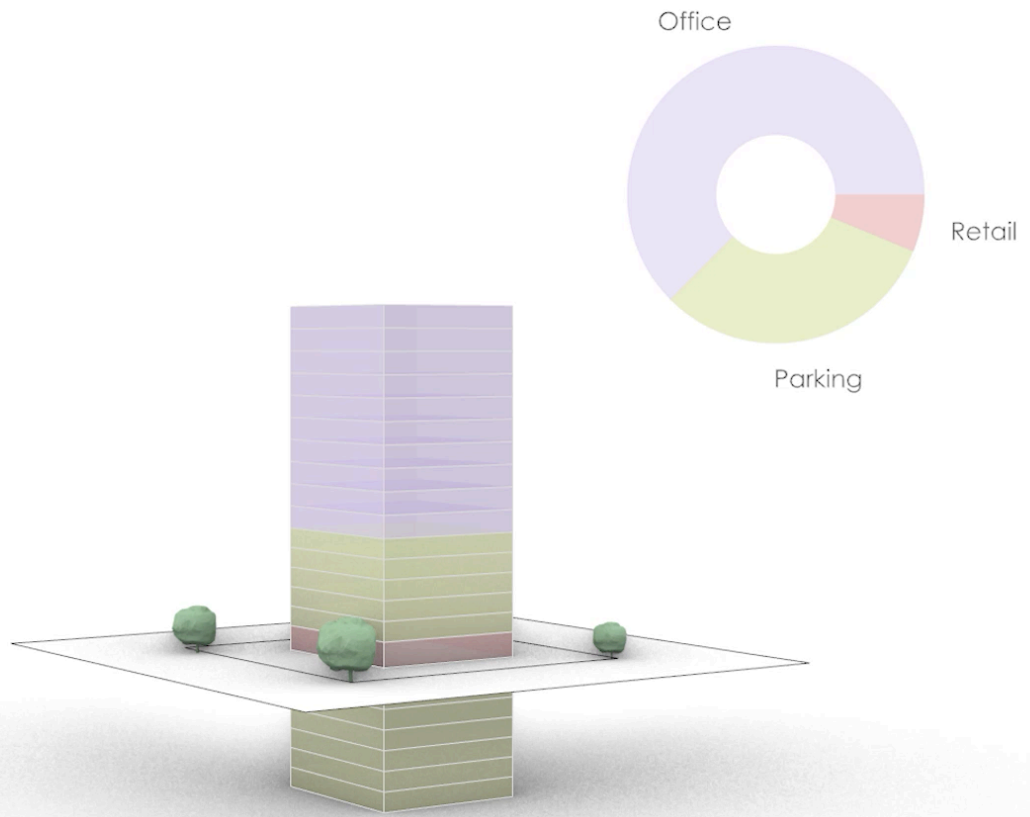

Architecture
Interior Design
Planning

Create Study

OpenOfficeLayout

Study Name

Method

Which inputs should vary? ▲

- Rotate -18 to 18
- Position on Room Surface (U) 0 to 10

Which outputs should be used as goals? ▲

- Desk Count
 - Minimize Maximize
- Area per Desk
 - Minimize Maximize
- Utilization
 - Minimize Maximize
- Number of Private Desks
 - Minimize Maximize

Which outputs should be constrained? ▲

- Desk Count
- Area per Desk
- Utilization
- Number of Private Desks

Generation Settings ▲

Population Size